



**STUART
CHARLES**
ESTATE AGENTS



Roman Road

, Corby, NN18 8GQ

£155,000



Roman Road

, Corby, NN18 8GQ

£155,000



Entrance Hall

Entered via a double glazed door, radiator, storage cupboard, doors to:

Lounge/Diner

17'3" x 16'0" (5.26m x 4.88m)

Two double windows to side and rear elevation, radiator, tv and telephone point, archway to:

Kitchen

12'7" x 4'11" (3.84m x 1.50m)

Fitted to comprise a range of base and eye level units with a single sink and drainer, gas hob with extractor, electric oven, integrated appliances, double glazed window to side elevation, extractor fan, wall mounted boiler.

Bedroom One

11'5" x 8'9" (3.48m x 2.67m)

Double glazed window to rear elevation, tv point, radiator, door to:

En-Suite

5'4" x 4'11" (1.63m x 1.50m)

Fitted to comprise a three piece suite consisting of a mains feed shower, low level pedestal, low level wash hand basin and radiator.

Bedroom Two

11'5" x 7'3" (3.48m x 2.21m)

Double glazed window to rear elevation, radiator.

Bathroom

8'3" x 5'1" (2.51m x 1.55m)

Fitted to comprise a three piece suite consisting of a panel bath with mains feed shower over, low level wash hand basin, low level pedestal, radiator and extractor fan.

Outside

Rear: An allocated parking space provides off road parking.



Road Map



Hybrid Map



Terrain Map

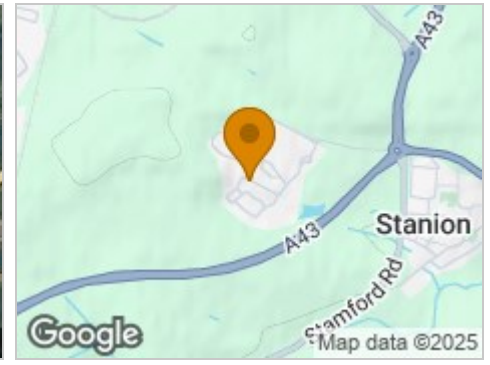

Floor Plan

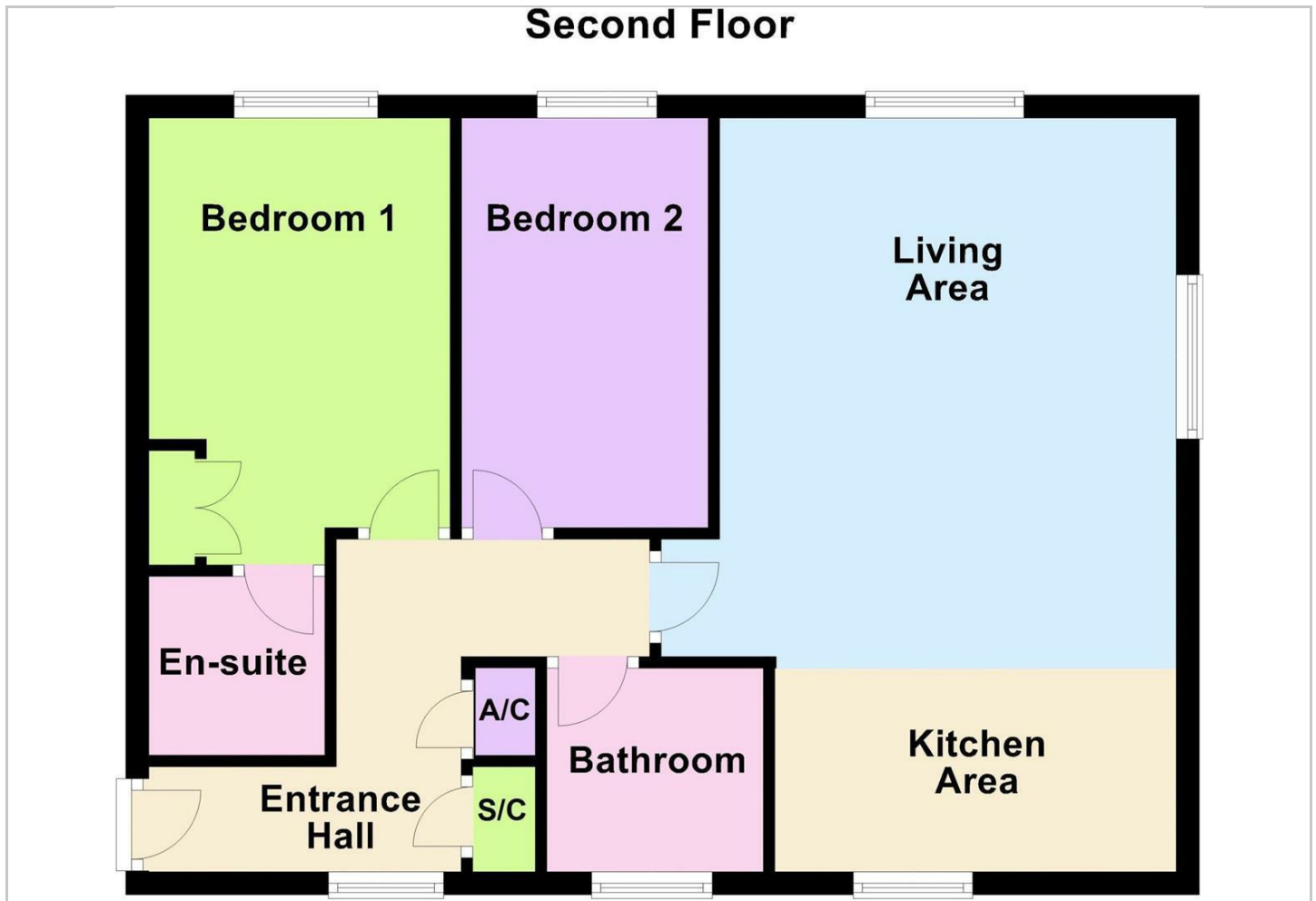

Viewing

Please contact our Stuart Charles Estate Agents Office on 01536 234264 if you wish to arrange a viewing appointment for this property or require further information.

Energy Efficiency Graph

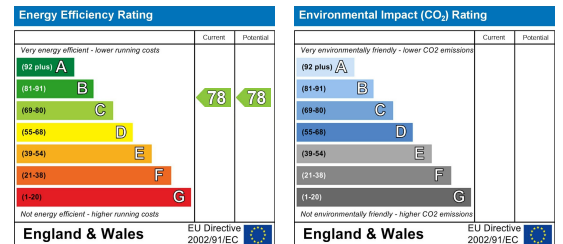

These particulars, whilst believed to be accurate are set out as a general outline only for guidance and do not constitute any part of an offer or contract. Intending purchasers should not rely on them as statements of representation of fact, but must satisfy themselves by inspection or otherwise as to their accuracy. No person in this firm's employment has the authority to make or give any representation or warranty in respect of the property.