



2 Culloden Court, Corby, NN17 1RB





## £194,950

Stuart Charles are delighted to offer for sale with NO CHAIN this three bedroom family home located in the desirable Town centre area of Corby. Situated a short walk away from a host of amenities to include the town centre shops, several schools and the train station an early viewing is recommended to avoid missing out on this home. The accommodation comprises to the ground floor of an entrance hall, lounge/diner, kitchen and utility room. To the first floor are three good sized bedrooms, a two piece family bathroom and a separate W.C. Outside to the front is a raised lawn, while to the rear a patio area leads onto a larger than average laid lawn and is enclosed by timber fencing to all sides. Call now to view!!.

- NO CHAIN
- KITCHEN WITH UTILITY ROOM
- TWO PIECE BATHROOM WITH SEPERATE W.C
- WALKING DISTANCE TO TOWN CENTRE
- L SHAPED LOUNGE/DINER
- THREE GOOD SIZED BEDROOMS
- LARGER THAN AVERAGE GARDEN
- CLOSE TO PRIMARY AND SECONDARY SCHOOL

### Entrance Hall

Entered via a double glazed door, radiator, stairs rising to first floor landing, door to:

### Lounge/Diner

19'75 x 13'26 (5.79m x 3.96m)

Double glazed window to front and rear elevation, two radiators, tv point, telephone point, storage cupboard, doors to:

### Kitchen

14'18 x 8'03 (4.27m x 2.51m)

Fitted to comprise a range of base and eye level units with a sone and a half bowl sink and drainer, electric hob and extractor, double electric oven, space for automatic washing machine, double glazed window to side elevation, door to:













### Utility Room

6'17 x 5'22 (1.83m x 1.52m)

Space for free standing fridge/freezer, door to airing cupboard.

### First Floor Landing

Loft access, doors to:

### Bedroom One

13'69 x 10'19 (3.96m x 3.05m)

Double glazed window to the front elevation, radiator, built in wardrobe.

### Bedroom Two

13'71 x 8'05 (3.96m x 2.57m)

Double glazed window to front elevation, radiator.









### Bedroom Three

10'25 x 7'24 (3.05m x 2.13m)

Double glazed window to rear elevation, radiator.

### Bathroom

Fitted to comprise a two piece suite consisting of panel bath with mains feed shower, low level wash hand basin, radiator, double glazed window to rear elevation.

### W.C

Fitted to comprise a low level pedestal, double glazed window to rear elevation.

### Outside

Front: A large laid lawn leads to gated side access.









Rear: A patio area leads onto a laid lawn and is enclosed by timber fencing to all sides.







## Ground Floor

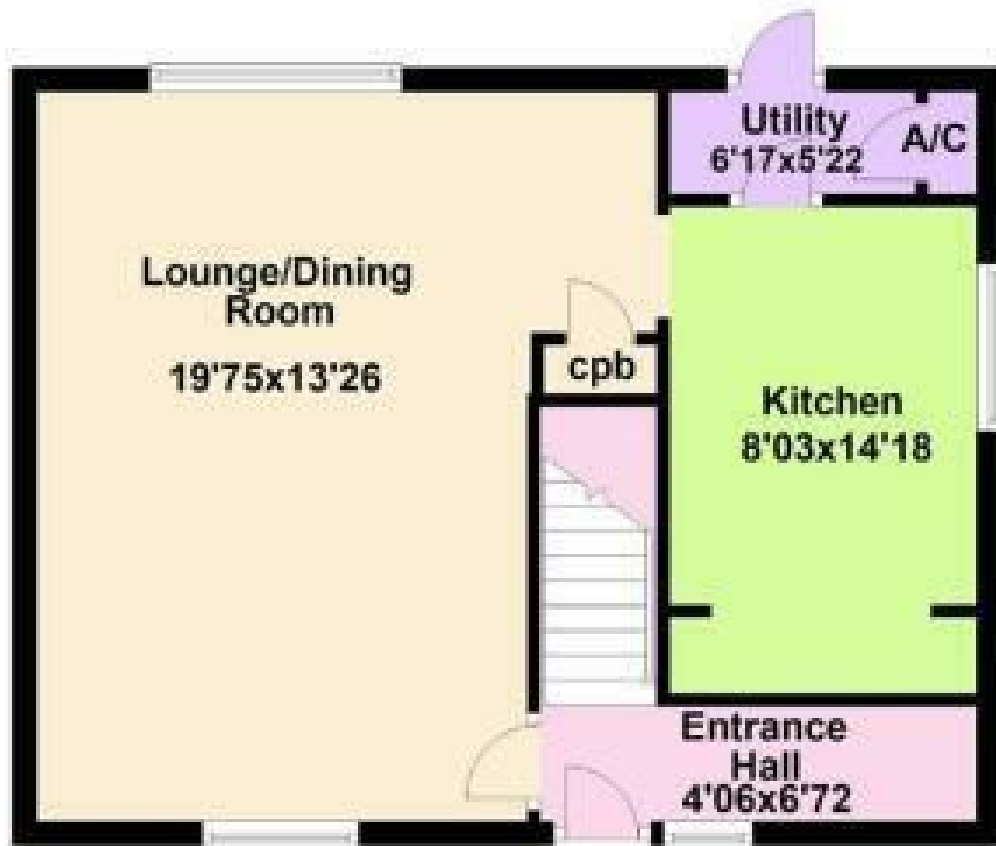

## First Floor

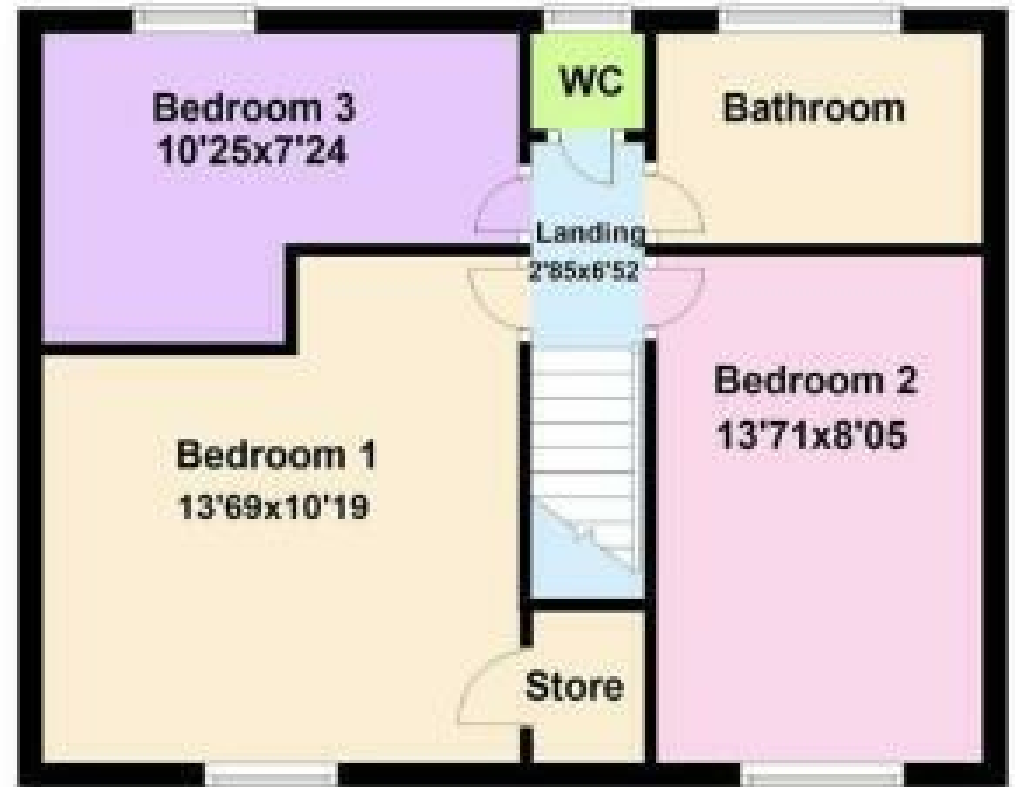

Floor plan not to scale - for guidance purposes only.  
Plan produced using PlanUp.



