



14 Pages Walk, Corby, Northamptonshire, NN17 1XE

£220,000

Stuart Charles are delighted to offer for sale this three bedroom DETACHED home located in the old village area of Corby. Within walking distance to the train station, primary and secondary schools and a host of amenities an early viewing is recommended to avoid missing out on this home!! The accommodation on offer comprises an entrance hall with guest WC, lounge and a good sized kitchen/diner. To the first floor are three well proportioned rooms, a large storage cupboard and a bathroom. Outside to the front is a laid lawn with picket fence surround while the rear garden has a mixture a patio and laid lawn, all enclosed by a timber fence surround. Call now to book a viewing!!

- OLD VILLAGE LOCATION
- PRIVATE GARDEN
- CLOSE TO LOCAL AMENITIES
- GREAT TRANSPORT LINKS
- DOWNSTAIRS WC
- THREE GOOD SIZE BEDROOMS
- WALKING DISTANCE TO SCHOOLS
- LARGE KITCHEN/DINER

Entrance Hall

Stairs rising to first floor landing, guest WC, radiator, doors to:

Guest WC

This two piece suite features a a low level wash hand basin, pedestal and double glazed window to the side elevation.

Lounge

15'11 x 12'06 (4.85m x 3.81m)

Double glazed window to the rear and front elevation, double glazed French doors to the rear elevation, radiators, Tv and Telephone points.

Kitchen/Diner

15'10 x 8'07 (4.83m x 2.62m)

Fitted to comprise a range of base and eye level units with a one bowl sink and drainer, space for a dishwasher, space







for free standing cooker, space for free standing fridge, radiator, double glazed window to the rear elevation, double glazed French doors to rear, doors to:

Landing

Airing cupboard, storage cupboard, loft access, doors to:

Bedroom One

16'00 x 11'06 (4.88m x 3.51m)

Double glazed window to the front elevation, radiator.

Bedroom Two

11'00 x 9'07 (3.35m x 2.92m)

Double glazed window to the front elevation, radiator.





Bedroom Three

10'09 x 6'05 (3.28m x 1.96m)

Double glazed window to the front elevation, built in wardrobe.

Bathroom

9'06 x 4'07 (2.90m x 1.40m)

Featuring a three piece suite with a panel bath and shower over, low level wash hand basin and pedestal, radiator, double glazed window to rear elevation.

Outside

To the front is a laid lawn with picket fence surround.

The rear garden has a mixture a patio and laid lawn, all enclosed by a timber fence surround.

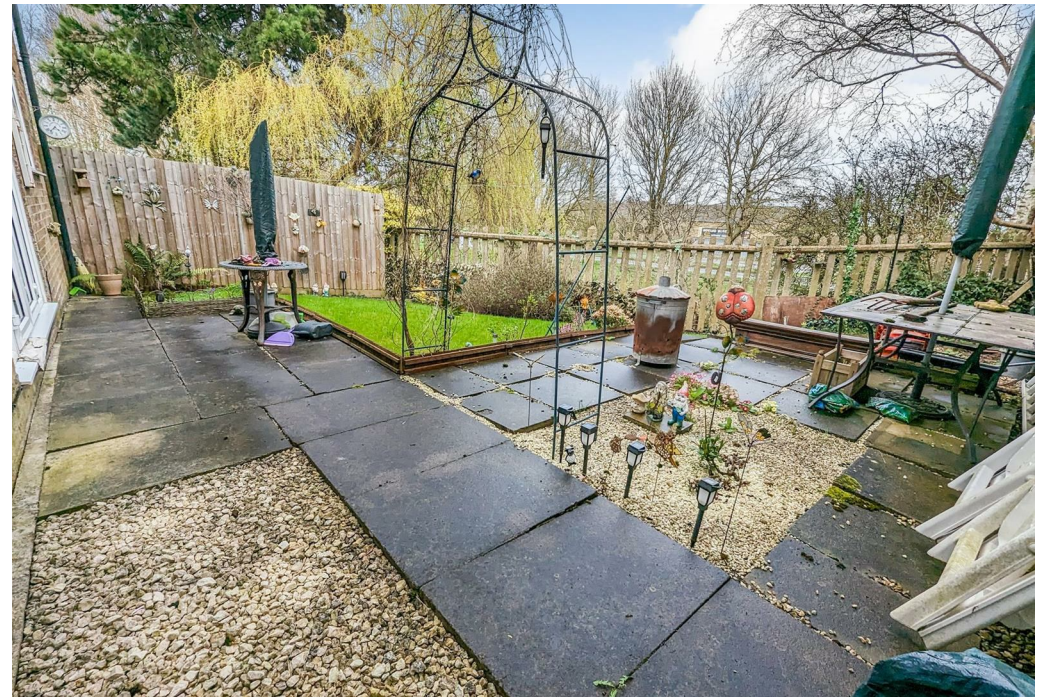





First Floor

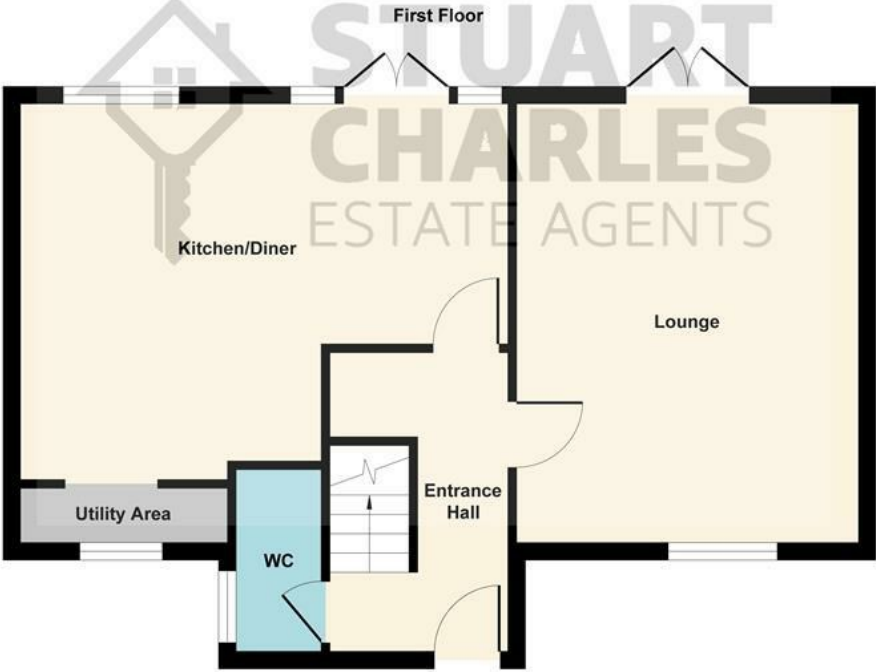

Ground Floor

Illustration for identification purposes only. Measurements are approximate, not to scale.
Produced by Elements Property

