



1 Northbrook, Corby, NN18 9AU



£180,000

Stuart Charles are delighted to offer for sale this cosy three bedroom semi-detached family home located in the Kingswood area of Corby. Situated a stone's throw away from Kingswood local nature reserve, several bus links and local shopping parade, an early viewing on this family home is highly recommended to avoid disappointment. The accommodation on offer comprises of an entrance hall, large lounge with views over the garden, modern kitchen/diner and utility room. To the first floor are three good sized bedrooms, of which, one is currently used as a dressing room, a separate W.C and a two piece bathroom suite. Outside to the front is a low maintenance frontage, to the rear a large patio area that leads onto an artificial lawn, surrounded by timber fencing, with an access gate leading you to the side elevation.

- MODERN FITTED KITCHEN!!
- THREE GOOD-SIZED BEDROOMS!!
- SEPARATE W.C. AND BATHROOM!!
- CLOSE TO LOCAL SCHOOLS!!
- CLOSE TO PUBLIC TRANSPORT LINKS!!
- LARGE KITCHEN/DINER!!
- POTENTIAL TO CREATE UTILITY ROOM!!
- LOW MAINTENANCE REAR GARDEN!!
- CLOSE TO NATURE RESERVE!!

Entrance Hall

Entered via a double glazed door, radiator, stairs rising to first floor landing, doors to:

Lounge

16'0" x 10'0" (4.88m x 3.05m)
Double glazed window to rear, radiator, tv point, telephone point, door to:

Kitchen/Diner

8'9" x 15'8" (2.69m x 4.8m)
Fitted to comprise a range of base and eye level units with steel sink and drainer, four ring gas hob, electric oven, space for dishwasher, space for washing machine, radiator, double glazed window to front elevation, double glazed patio doors to rear, door to:







Utility/W.C.

5'10" x 5'4" (1.78m x 1.63m)

low level wash hand basin, low level pedestal, storage room.

First floor landing

loft access, double glazed window to front elevation, doors to;

Bedroom One

10'11" x 12'11" (3.35m x 3.96m)

Double glazed window to rear, radiator.





Bedroom Two

6'3" x 9'10" (1.93m x 3m)

Double glazed window to rear, build in wardrobe, radiator.

Bedroom Three

7'8" x 9'10" (2.34m x 3m)

Double glazed window to rear, radiator.

W.C.

Featuring a low level pedestal and a double glazed window to the front elevation.





Bathroom

5'6" x 5'4" (1.68m x 1.63m)

Featuring a two piece suite with a white panel bath and electric shower over, a low level wash hand basin, radiator and double glazed window to front elevation.

Outside

Front: A low maintenance frontage with timber low level fencing and gate/

Rear: A large patio area leads out onto a large artificial lawn and is enclosed by timber fencing to all sides, to the side a pedestrian gate.



Ground Floor

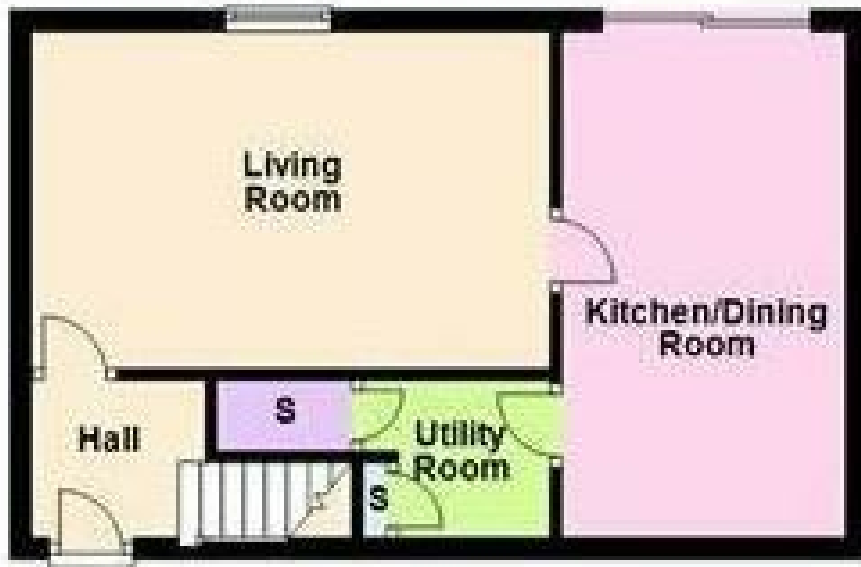

First Floor

